

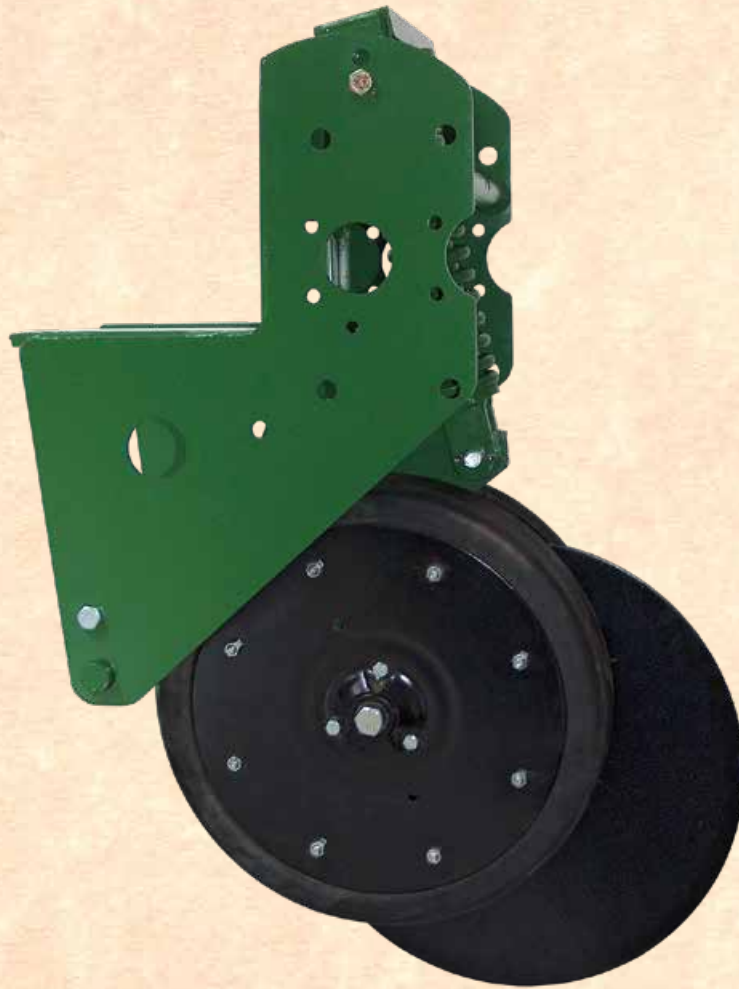

PEQUEA PLANTER

Residue Slicer Operators Manual



Pequea Planter LLC
561 White Horse Rd.
Gap, PA 17527
717-442-4406



RESIDUE SLICER INSTALLATION INSTRUCTIONS

It is important to install the Residue Slicer on a toolbar that is 20" from the ground in field conditions.

For best results blade (A) should be centered with the planter row unit.

The Residue Slicer has a lot of down force and it may be necessary to add up to 500 lb. of ballast per row for optimal performance.

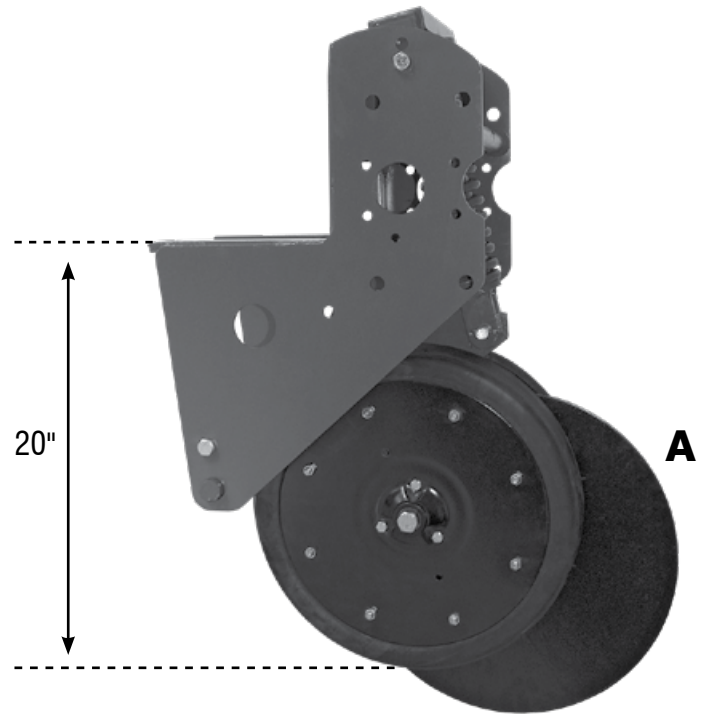

RESIDUE SLICER OPERATIONS AND MAINTENANCE INSTRUCTIONS

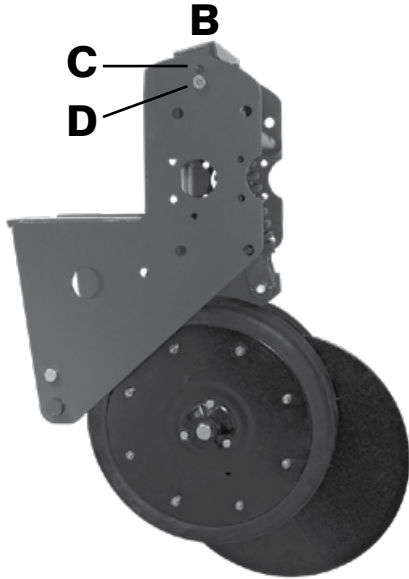

Adjust the bolt (B) that goes thru the spring for more or less down stroke in the field.

Adjusting bolt (B) will not increase or decrease down pressure.

For more down pressure, attach spring crossbar to hole (D) or (F).

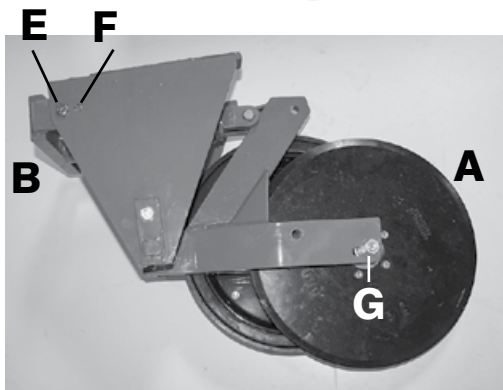

New blades (A) are 16" in diameter.

When blade wears down to 15" it can be moved to front hole (G). This will bring the blade versus wheel position correct again.

It may be necessary to sharpen the blade for high amounts of residue.

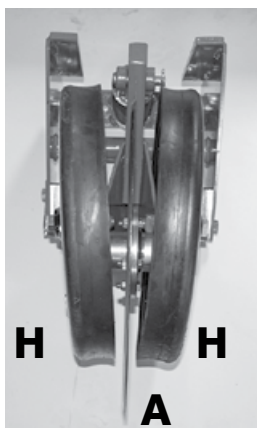

The wheels (H) should be set at 1/2" to 5/8" from the point of the blades (A).

Too close will cause excessive cutting of the tire.

Too far away will not hold the residue sufficiently.

It is not unusual to have some tire damage, if the tire is so far away it never gets cut, it is too far away for normal operation

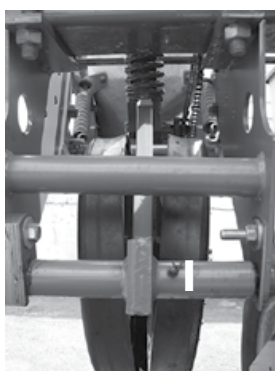

Grease zerker (I) every 4 hours of use.

RESIDUE SLICER PARTS BREAKDOWN

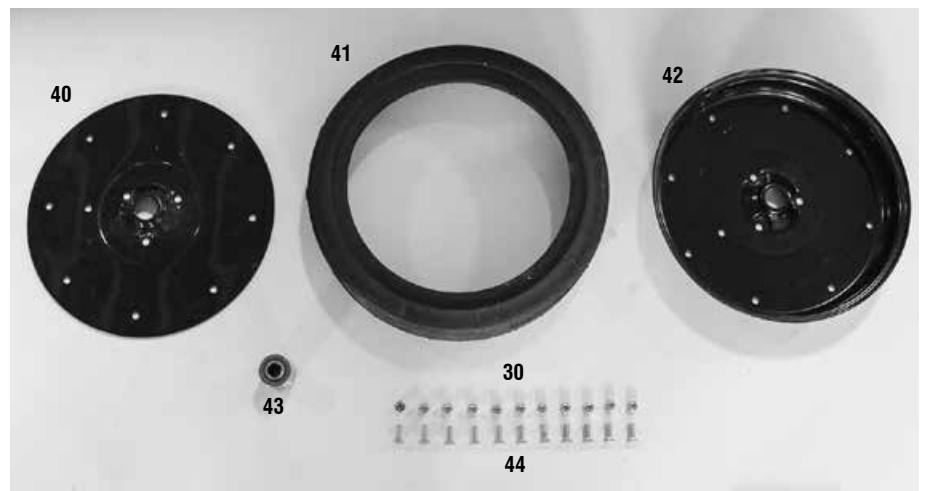
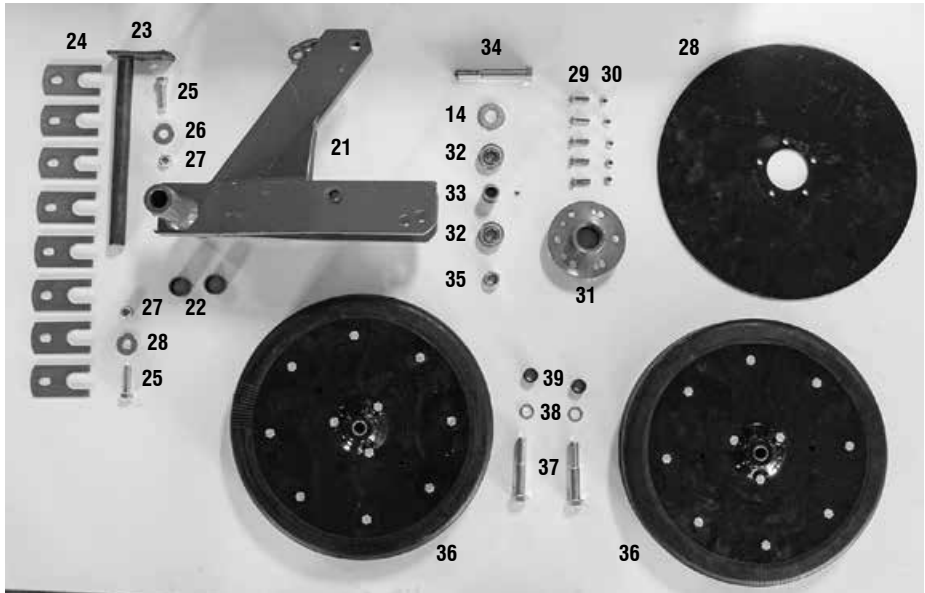
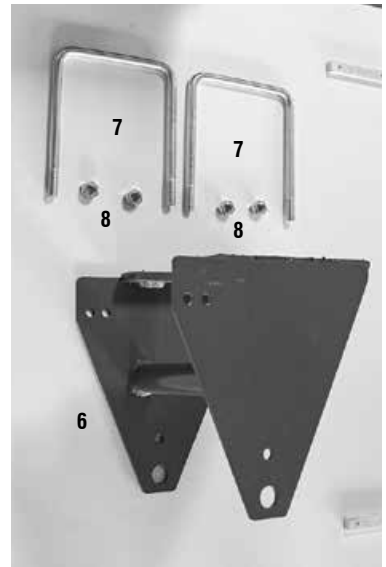
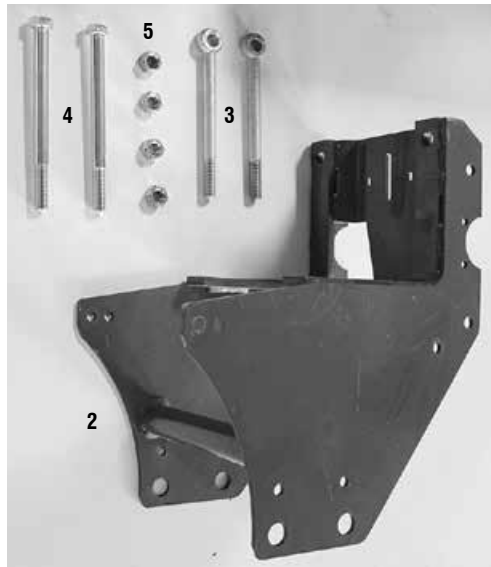
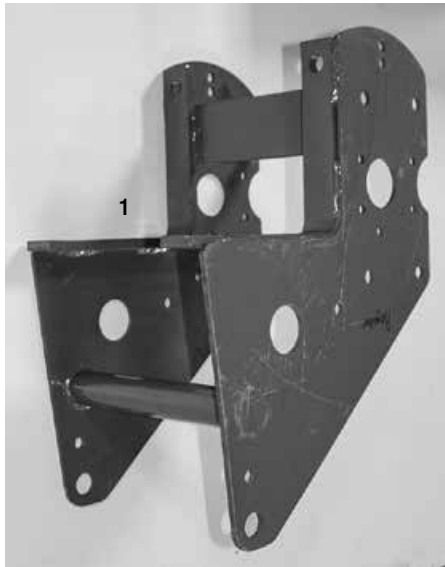



RESIDUE SLICER PARTS BREAKDOWN

| KEY | PART# | DESCRIPTION | QUANTITY | REMARKS |
|-----|--------|---------------------------|----------|--|
| 1 | PP6300 | Main Frame | 1 | Main frame 7" x 7", for 7200 & later, 4" setback, not compatible with HD down force |
| | PP6301 | Main Frame | 1 | Main frame, 7" x 7", for 7000, 4" setback |
| | PP6302 | Main Frame | 1 | Main frame, 5" x 7", for 7200 & later, 4" setback, not compatible with HD down force |
| | PP6303 | Main Frame | 1 | Main frame, 5" x 7", for 7000, 4" setback |
| | PP6304 | Main Frame | 1 | Main frame, 7" x 7", for 7200 and later, 6" setback |
| 2 | PP6305 | Main Frame | 1 | Main frame, 7" x 7", for 7200 and later, with spring below toolbar |
| | PP6306 | Main Frame | 1 | Main frame, 7" x 7", for 7000, with spring below toolbar |
| 3 | PP0604 | 3/4" x 9" eyebolt | 2 | Length is to center of hole |
| 4 | | 3/4" x 9 1/2" hex bolt | 2 | For 7" x 7" toolbar |
| | | 3/4" x 7 1/2" hex bolt | 2 | For 5" x 7" toolbar |
| 5 | | 3/4" nut | 4 | |
| 6 | PP6307 | Main Frame | 1 | Low profile, fits below 7" toolbar |
| 7 | | 5/8" x 7" x 7" U-bolt | 2 | |
| 8 | | 5/8" nut | 4 | |
| 9 | PP6308 | Crossbar | 1 | |
| 10 | | 1/2" x 1 1/2" hex bolt | 2 | Grade 8 |
| 11 | PP0609 | Bushing | 2 | Replaces JD # 24M7053 |
| 12 | | 1/2" flange lock nut | 2 | |
| 13 | | 5/8" x 7" all thread bolt | 1 | |
| 14 | | 5/8" flat washer | 2 | |
| 15 | | 5/8" reversible lock nut | 1 | |
| 16 | PP0610 | Spring | 1 | Replaces JD # A46832 |
| 17 | PP0611 | Clevis | 1 | Replaces JD # A46810 |
| 18 | PP0309 | Bushing | 2 | For clevis |
| 19 | PP0612 | 5/8" x 3" clevis pin | 1 | Hardened |
| 20 | | 5/32" x 1 1/4" cotter pin | 1 | |
| 21 | PP6309 | Arm | 1 | |
| 22 | PP0300 | Bushing | 2 | Replacement bushing for arm pivot |
| 23 | PP0606 | Shaft | 1 | Replaces JD # AA34049 |
| 24 | PP0605 | Shim | 8 | Replaces JD # A50749 |
| 25 | | 1/2" x 2" all thread bolt | 2 | |
| 26 | | 1/2" flat washer | 2 | |
| 27 | | 1/2" lock nut | 2 | |
| 28 | PP0310 | Blade | 1 | Replaces JD # A72358 |
| 29 | | 5/16" x 1" hex bolt | 5 | Grade 8 |
| 30 | | 5/16" lock nut | 27 | |
| 31 | PP8513 | Hub | 1 | |
| 32 | PP0654 | Bearing | 2 | Replaces JD # JD9214 |
| 33 | PP8514 | Spacer | 1 | Between bearings |
| 34 | | 5/8" x 4 1/2" hex bolt | 1 | |
| 35 | | 5/8" lock nut | 1 | |
| 36 | PP2298 | Wheel | 2 | 2 1/2" x 16" |
| 37 | | 5/8" x 3 1/2" hex bolt | 2 | |
| 38 | PP1077 | Shim | ? | Use in combination with PP0405 to space wheel 1/2" to 5/8" from blade |
| 39 | PP0405 | Bushing | ? | Use in combination with PP1077 to space wheel 1/2" to 5/8" from blade |
| 40 | PP6040 | Outer rim | 2 | |
| 41 | PP2299 | Tire | 2 | |
| 42 | PP2296 | Inner rim | 2 | |
| 43 | PP0404 | Bearing | 2 | |
| 44 | | 5/16" x 3/4" hex bolt | 22 | |

